

Fitting Guide

1



Preparation

Measure the hips and waist and using the larger of these two measurements ensure that the correct product size is selected.

2

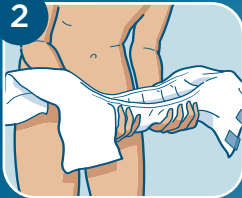

Preparation

Open the product fully and fold and cup the pad as shown. Position the end with the tapes to the back ensuring that the wings are fully opened before applying the pad. Make sure the waterproof backing of the Slip is on the outside and the soft white inner lining is next to the skin.

3



Positioning

Position the pad between the legs so that it fits snugly to the wearer and that it fits comfortably in the groin area. Use the wetness indicator to help to position and centre the pad.

4



Tape Fixation

Before placing the blue fixation tapes, make sure the tapes are positioned correctly. Once fixated to the slip, any attempt to remove the blue tape, will tear the pad.

5

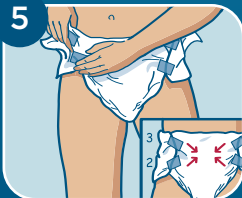

Fitting

Gently pull the wing around to the front of the pad and fasten the tapes. Fasten the bottom tapes first in an upwards direction to give a close fit around the groin area and then fasten the top tapes in a downwards direction to ensure a snug, comfortable fit.

When you remove the Slip lift the white tape off the blue tape.

Hints and Tips

Selection

- Choose the Slip according to hip or waist size – whichever is the largest

Fitting

- Ensure you keep the ruffles on the flexible leg gathers on the outside of the Slip – this keeps the waterproof back sheet away from the skin
- Keep the adhesive tapes at the back when fitting the Slip – you then know it is the right way round
- When fastening the Slip, fasten the bottom tapes first in an upwards direction and then the top tapes in a downwards direction to give a snug, comfortable fit
- If the product is fitted when the wearer is lying down, to make sure the pad stays in place, place a hand on the back of the Slip when the user is turned from their side on to their back
- Use the wetness indicator to centre the whole pad

Changing

- Check the wetness indicator - if the wetness indicator has disappeared over half the length of the pad, the product requires changing. If not the pad can be reapplied
- Reseal and reuse the Slip when toileting if the product is clean and dry
- When undoing the tapes the blue tape should remain in place on the product
- Do not stick tapes to the skin
- Clean skin as per your local policy. Clean from front to back
- Avoid oil based creams if possible and powders should not be used at all as these will affect the absorbency of the pad, preventing urine being absorbed and placing the skin at risk

Leakage

- Check fitting
- Check sizing

Disposal

- Roll up pads and dispose properly in a bin
- Do not flush the pad down the toilet